

State this tract to be abt 30 miles from Philada Micho Scull

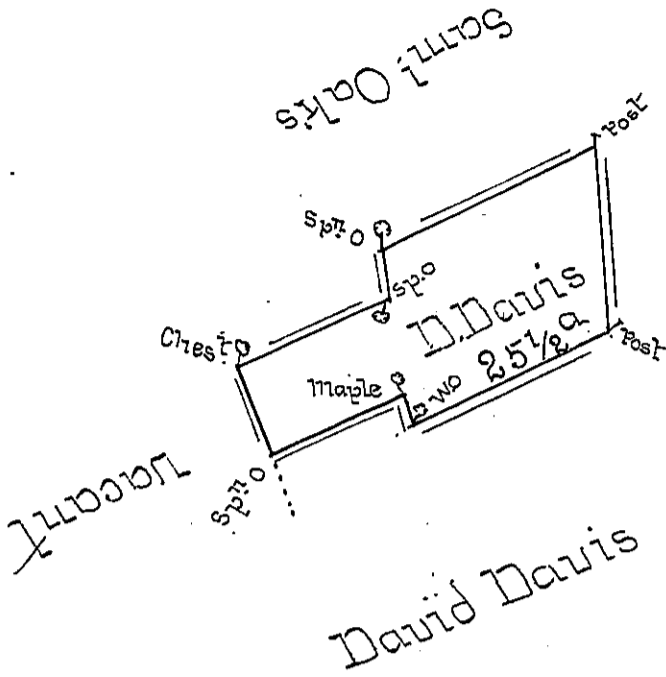

Pursuant to an Order Dated the 13th of August Anno Dom 1748 The above Described Piece of Land was Surveyed for the Use of y^e Proprietaries in y^e Township of Loshen Chester Co. Beginning at a Post at a Corner of y^e Band of David Davis. Thence by y^e Same w.s.w. 72 pches to a W^t Oak and N. 20^d west 6 1/2 pc obl. to a Maple and W.S.W. 50 pces to a Span. Oak Thence N. 25. W. by Vac^t L^d 30 pces to a Chestnut Thence by y^e Settlement of Sand Oaks N. 65^d E. 58 P. to a Span^d O. & N. 3^d W. 17 pches to a Sp^o O. & N. 65^d E 80 P. to a Post Thence S 3^d E by y^e line of John Heall 62 P to y^e place of Begⁿ Cont^a 35 1/2 as & alle

Sam^l Lightgo^robl.

IN TESTIMONY that the above is a copy of the original remaining on file in the Department of Internal Affairs of Pennsylvania, made conformably to an Act of Assembly approved the 16th day of February, 1833, I have hereunto set my Hand and caused the Seal of said Department to be affixed at Harrisburg, this

—second— day of —March— 1897—

James W. Fatta
 Secretary of Internal Affairs.